

# NEXO

# Dory

Version 2.0

in **5** little steps

## 1 Connect your DTD

Install NEXO Dory.

Simply plug a USB cable between your DTD and your computer or mobile terminal (a USB OTG adapter is needed to connect to an Android device, which should support OTG).

Launch NEXO Dory.

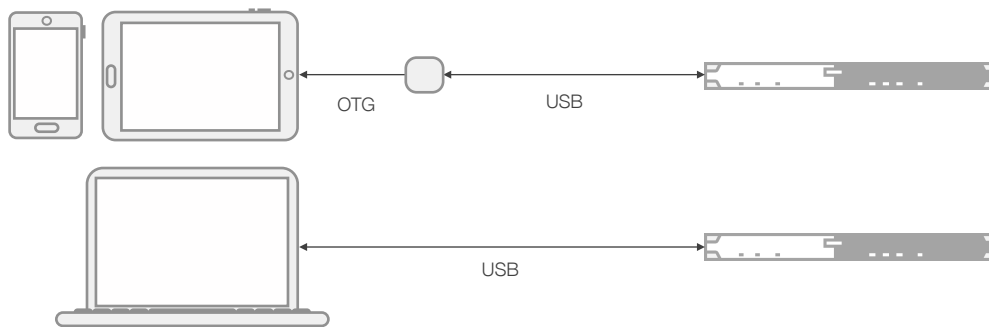

## 2 Choose presets

Press the cabinet icon of a main cabinet to edit the main preset.

Choose a cabinet and the cross-over mode.

Press the sub icon to edit the sub preset.

Choose a cabinet and the cross-over mode.

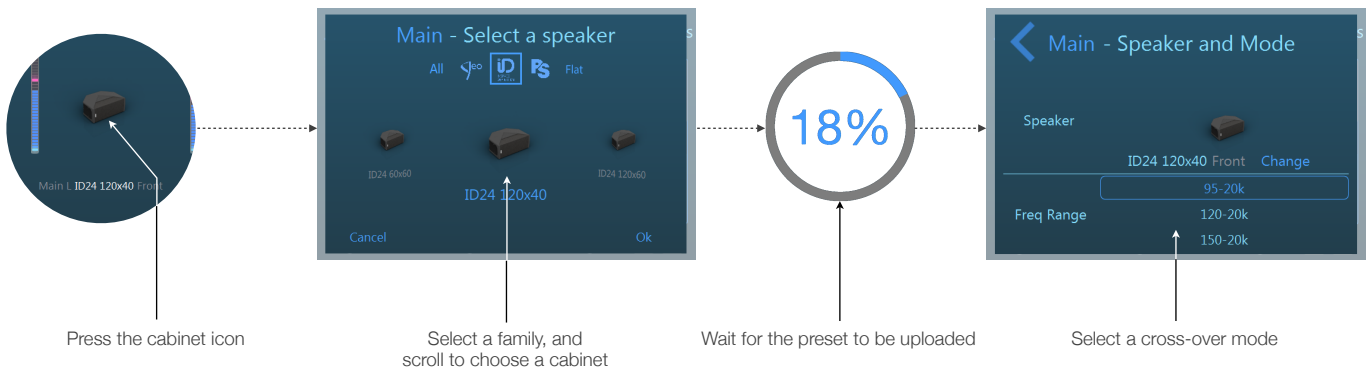

# 3 Patch the inputs

Go to the Inpatch view.

Patch inputs to the pre-processing channels. The pre-processing channels will later be patched to the output channels.

Add and edit up to 8 EQ bands per pre-processing channel.

Press to patch

Double tap to add a band

Edit type, copy/paste or delete band

Set the band ON or OFF

Edit pre-processing EQ

Set the EQ of the pre-processing channel ON or OFF

Digital is either Dante or USB Audio

# 4 Prepare Your DTD's Settings and Compression

Go to the Output view.

Choose the pre-processing patch for the output channels.

Edit the gains and delays.

Edit the compressor.

Edit gain. This gain is combined with the front-panel gain (DTD-T only)

Slide or type to edit delay

Patch pre-processing channels

Edit several channel at once, absolute or relative

Edit the threshold

Edit the compression ratio

Edit compressor

Set the compressor of the output channel ON or OFF

# 5 Let the show begin

Input music through one of the possible inputs : analog, AES/EBU, Dante or audio over USB.

Monitor the output levels and the user compression level.

### Optional:

Go to the Settings view.

Choose a password (and don't forget it ;-)).

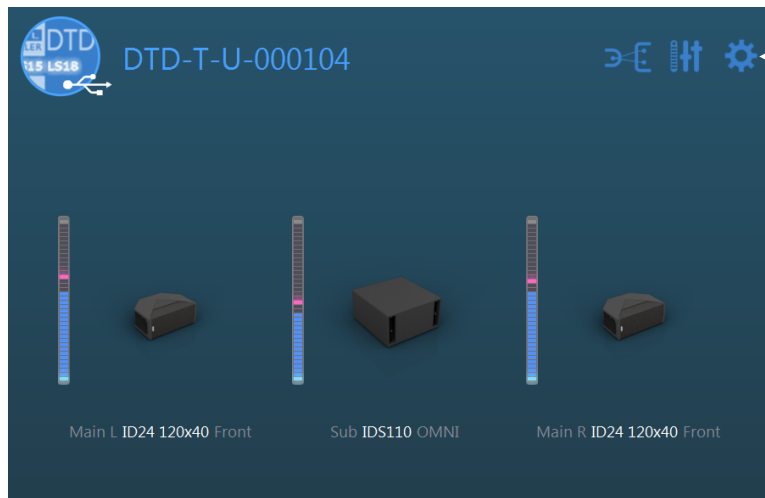
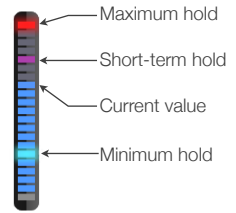

Thanks for downloading and using NEXO Dory! Please refer to the manual for further instructions and tips on how to use NEXO Dory: <https://nexo-sa.com/products/dory/>. Your feedback and comments are most welcome: [technical@nexo.fr](mailto:technical@nexo.fr).

© 2017 NEXO SA. All rights reserved. [www.nexo-sa.com](http://www.nexo-sa.com). **NEXO SA cannot be held responsible for damages caused by improper use of the devices, this software and its manual. The practices contained herein may not apply to every situation.**

Android is a trademark of Google Inc., registered in the U.S. and other countries. Dante and Dante logo are trademarks of Audinate Pty Ltd. Windows is a registered trademark of Microsoft Corporation. All other trademarks are the property of their owners.